



**RF/MICROWAVE**

**Coaxial Connectors**

**TAIWANGAST INC.**

2F, No.27, Jhong-Rong St., Sin-Jhuang City, Taipei County 242, Taiwan

TEL. 886 2 8994 1601, FAX. 886 2 8994 1602

sales@rfconnector.com.tw, www.rfconnector.com.tw

# General Information

<b>SMA</b>	<b>Subminiature Connectors Screw Lock</b>	<b>50 Ω</b>	<b>18 GHz</b>
<b>SMB</b>	<b>Subminiature Connectors Snap Lock</b>	<b>50 Ω 75 Ω</b>	<b>4 GHz 3 GHz</b>
<b>MCX</b>	<b>Microax Connectors Snap Lock</b>	<b>50 Ω 75 Ω</b>	<b>6 GHz 3 GHz</b>
<b>MMCX</b>	<b>Miniature Microax Connectors Snap Lock</b>	<b>50 Ω</b>	<b>6 GHz</b>
<b>N</b>	<b>Coaxial Connectors Screw Lock</b>	<b>50 Ω 75 Ω</b>	<b>11 GHz 1.5 GHz</b>
<b>TNC</b>	<b>Coaxial Miniature Connectors Screw Lock</b>	<b>50 Ω 75 Ω</b>	<b>11 GHz 1 GHz</b>
<b>BNC</b>	<b>Coaxial Miniature Connectors Bayonet Lock</b>	<b>50 Ω 75 Ω</b>	<b>4 GHz 1 GHz</b>
<b>FME</b>	<b>Coaxial Miniature Connectors Screw Lock</b>	<b>50 Ω</b>	<b>3 GHz</b>
<b>F</b>	<b>Coaxial Connectors Screw Lock</b>	<b>75 Ω</b>	<b>1 GHz</b>
<b>1.6/5.6</b>	<b>Coaxial Connectors Screw Lock</b>	<b>75 Ω</b>	<b>1 GHz</b>
<b>7/16</b>	<b>Coaxial Connectors Screw Lock</b>	<b>50 Ω</b>	<b>7.5 GHz</b>
<b>Adaptors</b>	<b>Between Series</b>		

## **TAIWANCAST INC.**

2F, No.27, Jhong-Rong St., Sin-Jhuang City, Taipei County 242, Taiwan

TEL. 886 2 8994 1601, FAX. 886 2 8994 1602, sales@rfconnector.com.tw, www.rfconnector.com.tw

# RF Connector Number Legend

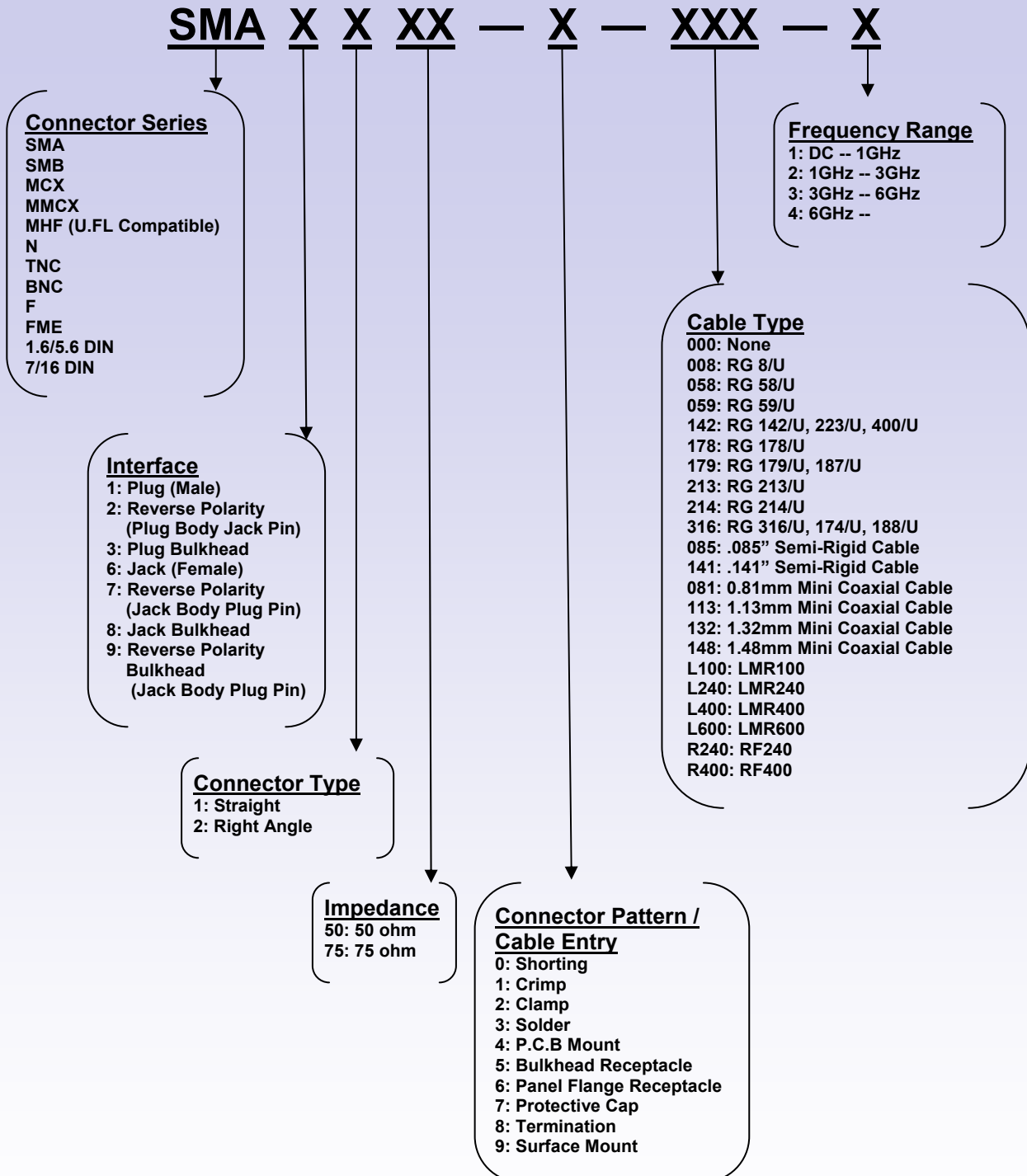

## TAIWANCAST INC.

2F, No.27, Jhong-Rong St., Sin-Jhuang City, Taipei County 242, Taiwan

TEL. 886 2 8994 1601, FAX. 886 2 8994 1602, sales@rfconnector.com.tw, www.rfconnector.com.tw

# RF Adapter Number Legend

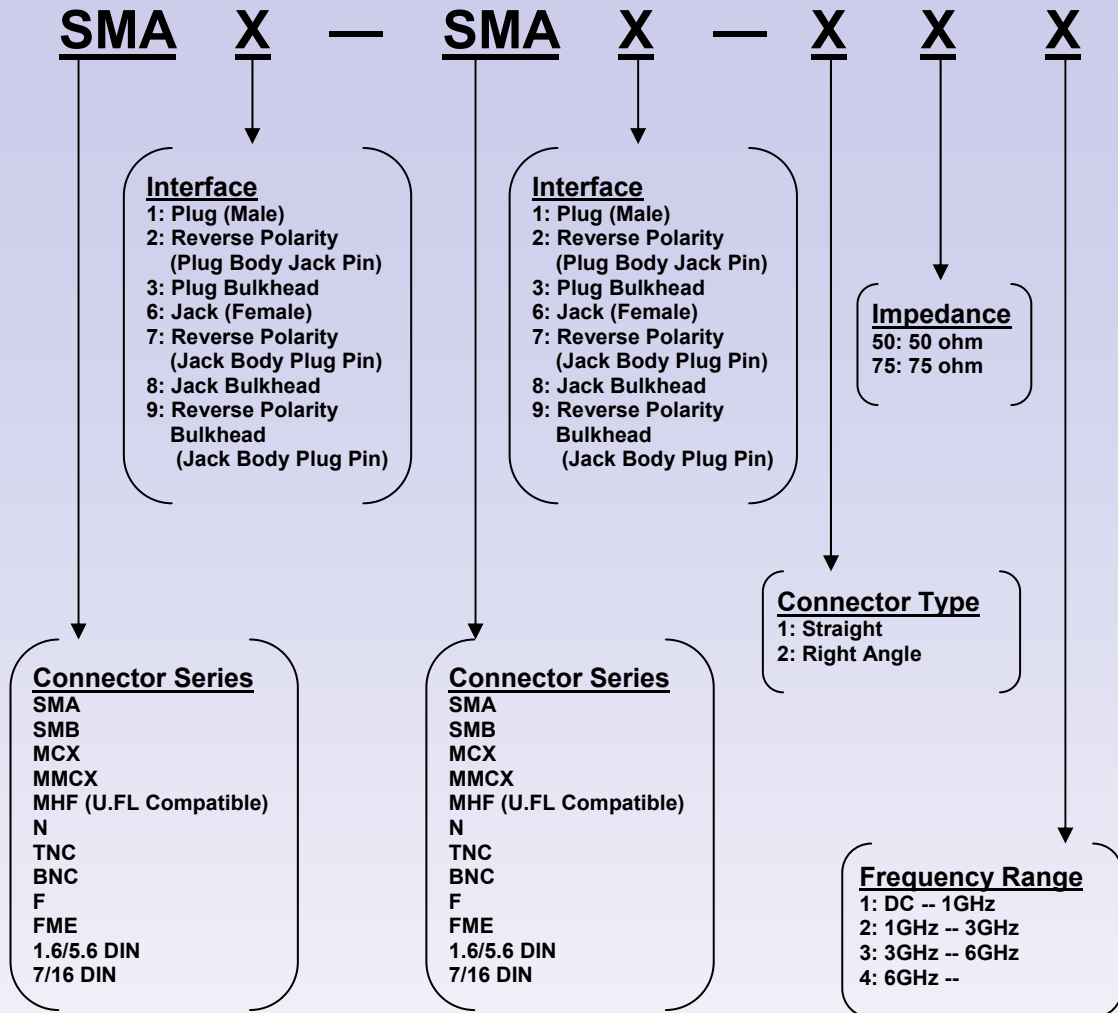

## TAIWANCAST INC.

2F, No.27, Jhong-Rong St., Sin-Jhuang City, Taipei County 242, Taiwan

TEL. 886 2 8994 1601, FAX. 886 2 8994 1602, sales@rfconnector.com.tw, www.rfconnector.com.tw

# RF Cable Assembly Number Legend

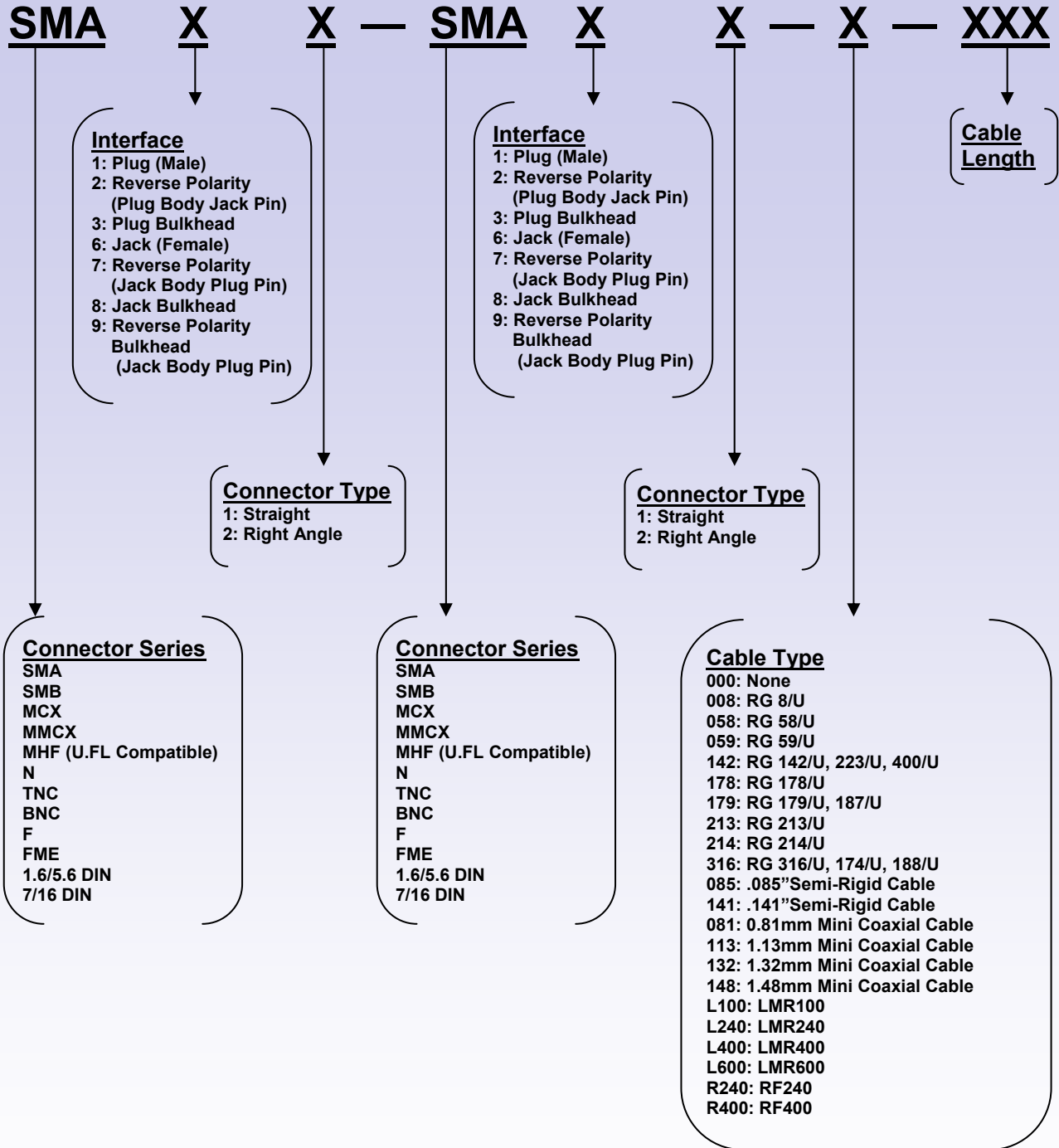

## TAIWANCAST INC.

2F, No.27, Jhong-Rong St., Sin-Jhuang City, Taipei County 242, Taiwan

TEL. 886 2 8994 1601, FAX. 886 2 8994 1602, sales@rfconnector.com.tw, www.rfconnector.com.tw

# N SERIES

The N Series screw-type coupling mechanism provides a sturdy and reliable connection. N series connectors are most suitable when high performance and precision are necessary.

## Applications:

- ◆ Antennas
- ◆ Cellular
- ◆ Mil-Aero
- ◆ WLAN
- ◆ PCS
- ◆ Base Stations
- ◆ Components
- ◆ Surge Protection
- ◆ Broadcast
- ◆ Radios
- ◆ Cable Assemblies
- ◆ Instrumentation
- ◆ Radar
- ◆ Microwave Radio
- ◆ Satcom

## Interface Mating Dimensions:

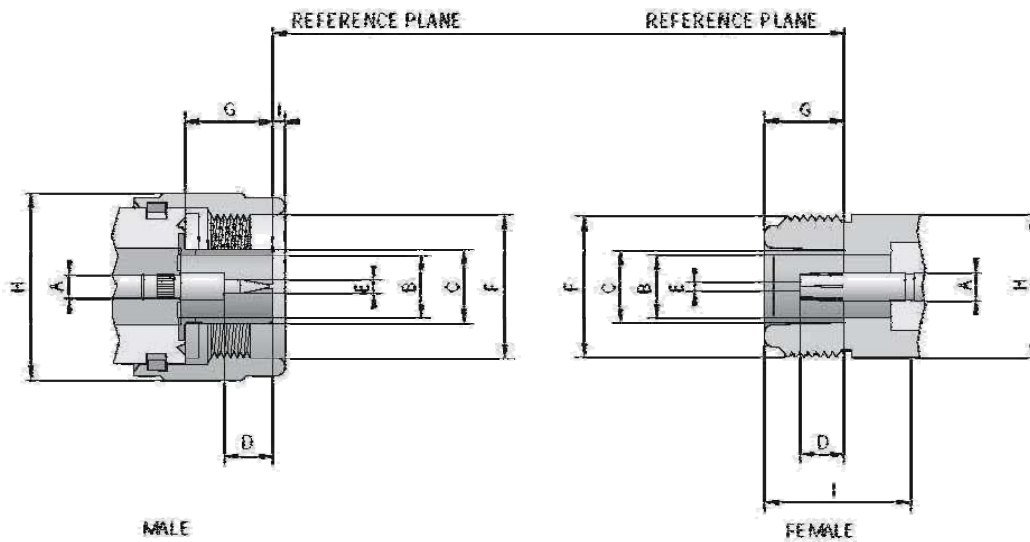

Interface Dimension in Millimeters					
Male			Female		
	Min.	Max.		Min.	Max.
A	3.04 nom		A	3.04 nom	
B	7.00 nom		B		7.06
C		8.03	C	8.03	8.13
D	5.33	5.84	D	4.75	5.26
E	1.60	1.68	E	Resilient dim.	
F	5/8-24UNEF-2B		F	5/8-24UNEF-2A	
G	10.11	10.46	G	9.04	9.19
H		21.00	H		15.93
I	0.41	1.52	I		10.72

## TAIWANCAST INC.

2F, No.27, Jhong-Rong St., Sin-Jhuang City, Taipei County 242, Taiwan

TEL. 886 2 8994 1601, FAX. 886 2 8994 1602, sales@rfconnector.com.tw, www.rfconnector.com.tw

## Technical Characteristics

### Electrical

Impedance	<b>50 ohm / 75 ohm</b>	
Frequency Range	<b>0 – 11 GHz/ 0 – 1.5 GHz</b>	
Working Voltage	1000 VRMS max.	
Dielectric Withstanding Voltage	2500VRMS	
VSWR	Straight	1.3 max.
	Right Angle	1.5 max.
Contact Resistance	Center Contact	3 Milliohm Max.
	Outer Contact	2 Milliohm Max.
Insulator Resistance	5000 Mega ohms min.	

### Material:

Part Name	Material	Finish
Body, Metal Parts	Brass	Nickel
Center Contacts	Plug: Brass	Gold
	Jack: Brass, Beryllium Copper, Phosphor Bronze	Gold
Insulator	PTFE or Derlin	
Crimp Ferrule	Annealed Copper	Nickel
Clamp Gaskets	Silicone Rubber or Rubber	

### Mechanical & Environmental

Engagement Force	6 in-lbs. max
Disengagement Force	6 in-lbs max.
Coupling Nut Retention	100 lbs. min.
Coupling Proof Torque	30 in-lbs. min.
Contact Retention	6 lbs. min.
Durability (Mating)	500 cycles min. (For Be/Cu Jack Contact only)
Temperature Range	-65°C ~ 165°C
Vibration	MIL-STD-202 Meth. 204/B
Salt Spray	MIL-STD-202 Meth. 101/B
Thermal Shock	MIL-STD-202 Meth. 107/B

## TAIWANCAST INC.

2F, No.27, Jhong-Rong St., Sin-Jhuang City, Taipei County 242, Taiwan

TEL. 886 2 8994 1601, FAX. 886 2 8994 1602, sales@rfconnector.com.tw, www.rfconnector.com.tw

# N SERIES

**N1150-1-XXX**  
**N STR. PLUG CRIMP TYPE**  
Suitable Cable:  
(1) LMR100  
(2) LMR240  
(3) LMR400



**N1150-1-XXX**  
**N STR. PLUG CRIMP TYPE**  
Suitable Cable:  
(1) RG174, RG188, RG316  
(2) RD316



**N1150-2-XXX**  
**N STR. PLUG CLAMP TYPE**  
**FOR 1/2 INCH CABLE**



**N1150-2-XXX**  
**N STR. PLUG CLAMP TYPE**  
Suitable Cable:  
(1) RG58  
(2) RG8, RG213, RG393



**N1150-3-XXX**  
**N STR. PLUG SOLDER TYPE**  
Suitable Semi-Rigid Cable:  
(1) .085  
(2) .141



**N1250-1-XXX**  
**N R/A PLUG CRIMP TYPE**  
Suitable Cable:  
(1) RG174, RG188, RG316  
(2) RD316



## **TAIWANCAST INC.**

2F, No.27, Jhong-Rong St., Sin-Jhuang City, Taipei County 242, Taiwan  
TEL. 886 2 8994 1601, FAX. 886 2 8994 1602, sales@rfconnector.com.tw, www.rfconnector.com.tw



# N SERIES

**N6150-2-XXX**  
**N STR. JACK CLAMP TYPE**  
**FOR 1/2 INCH CABLE**



**N6150-2-XXX**  
**N STR. JACK CLAMP TYPE**  
**(1)RG58**  
**(2)RG8, RG213, RG393**



## **TAIWANGCAST INC.**

2F, No.27, Jhong-Rong St., Sin-Jhuang City, Taipei County 242, Taiwan

TEL. 886 2 8994 1601, FAX. 886 2 8994 1602, sales@rfconnector.com.tw, www.rfconnector.com.tw