



RF/MICROWAVE

Coaxial Connectors

TAIWANGAST INC.

2F, No.27, Jhong-Rong St., Sin-Jhuang City, Taipei County 242, Taiwan

TEL. 886 2 8994 1601, FAX. 886 2 8994 1602

sales@rfconnector.com.tw, www.rfconnector.com.tw

General Information

SMA	Subminiature Connectors Screw Lock	50 Ω	18 GHz
SMB	Subminiature Connectors Snap Lock	50 Ω 75 Ω	4 GHz 3 GHz
MCX	Microax Connectors Snap Lock	50 Ω 75 Ω	6 GHz 3 GHz
MMCX	Miniature Microax Connectors Snap Lock	50 Ω	6 GHz
N	Coaxial Connectors Screw Lock	50 Ω 75 Ω	11 GHz 1.5 GHz
TNC	Coaxial Miniature Connectors Screw Lock	50 Ω 75 Ω	11 GHz 1 GHz
BNC	Coaxial Miniature Connectors Bayonet Lock	50 Ω 75 Ω	4 GHz 1 GHz
FME	Coaxial Miniature Connectors Screw Lock	50 Ω	3 GHz
F	Coaxial Connectors Screw Lock	75 Ω	1 GHz
1.6/5.6	Coaxial Connectors Screw Lock	75 Ω	1 GHz
7/16	Coaxial Connectors Screw Lock	50 Ω	7.5 GHz
Adaptors	Between Series		

TAIWANCAST INC.

2F, No.27, Jhong-Rong St., Sin-Jhuang City, Taipei County 242, Taiwan

TEL. 886 2 8994 1601, FAX. 886 2 8994 1602, sales@rfconnector.com.tw, www.rfconnector.com.tw

RF Connector Number Legend

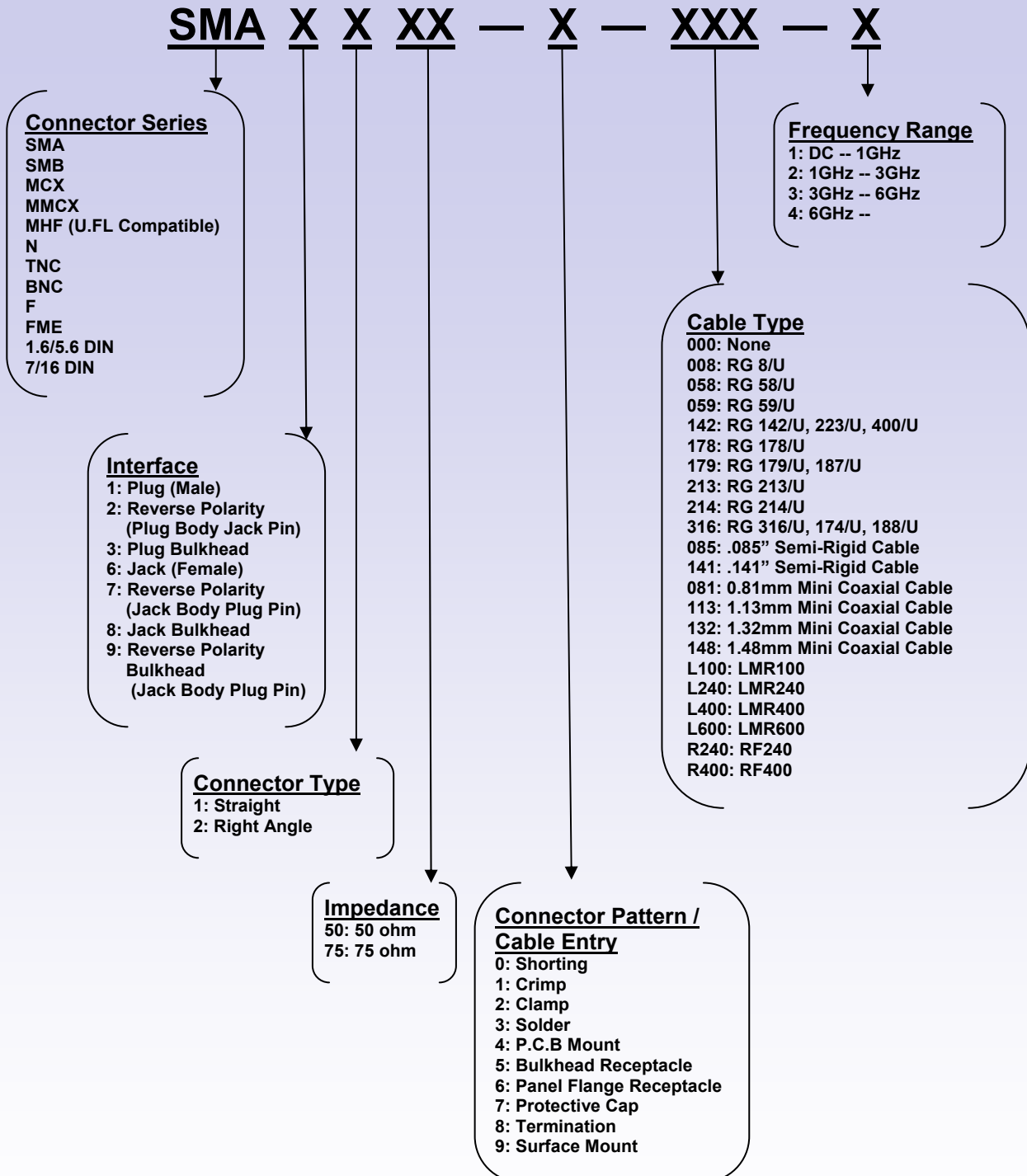

TAIWANCAST INC.

2F, No.27, Jhong-Rong St., Sin-Jhuang City, Taipei County 242, Taiwan

TEL. 886 2 8994 1601, FAX. 886 2 8994 1602, sales@rfconnector.com.tw, www.rfconnector.com.tw

RF Adapter Number Legend

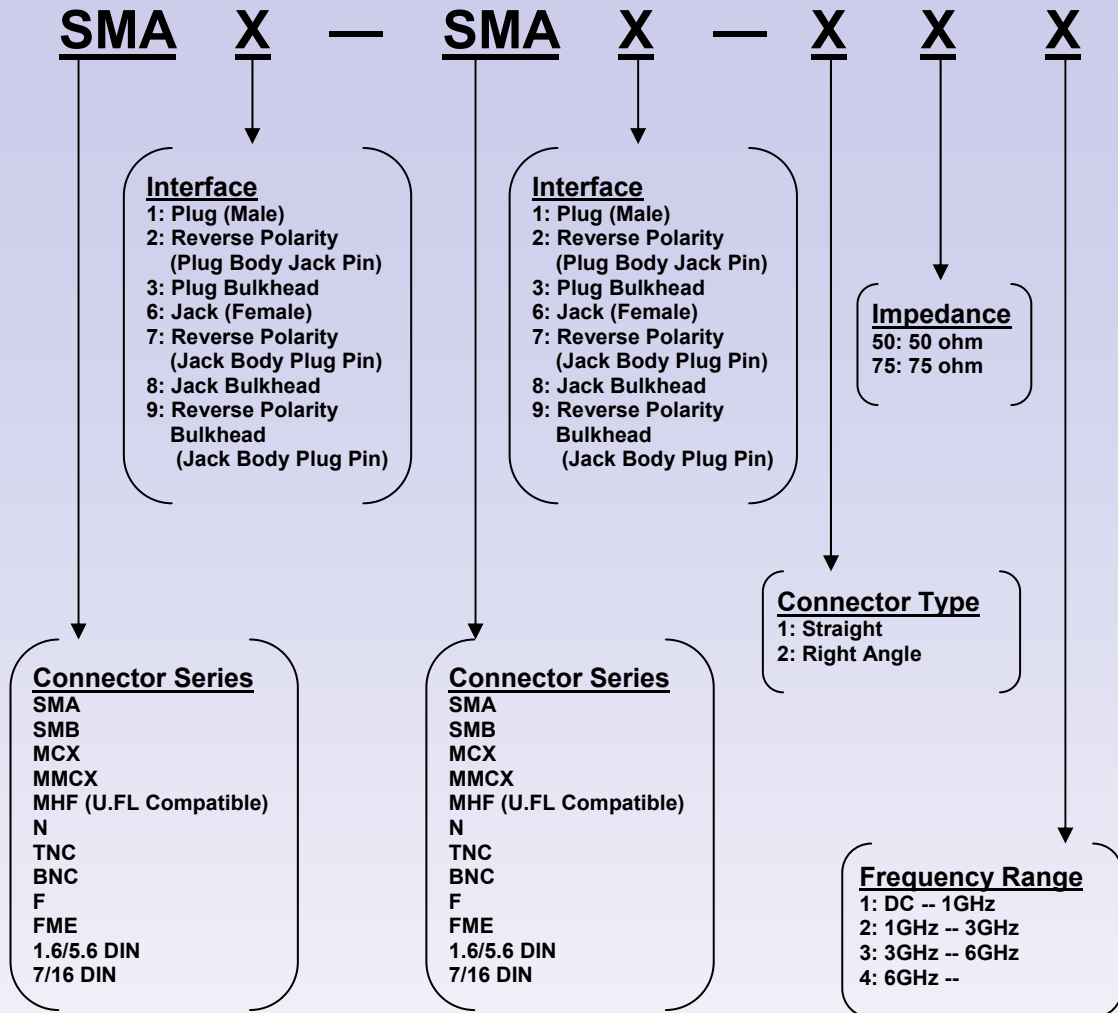

TAIWANCAST INC.

2F, No.27, Jhong-Rong St., Sin-Jhuang City, Taipei County 242, Taiwan

TEL. 886 2 8994 1601, FAX. 886 2 8994 1602, sales@rfconnector.com.tw, www.rfconnector.com.tw

RF Cable Assembly Number Legend

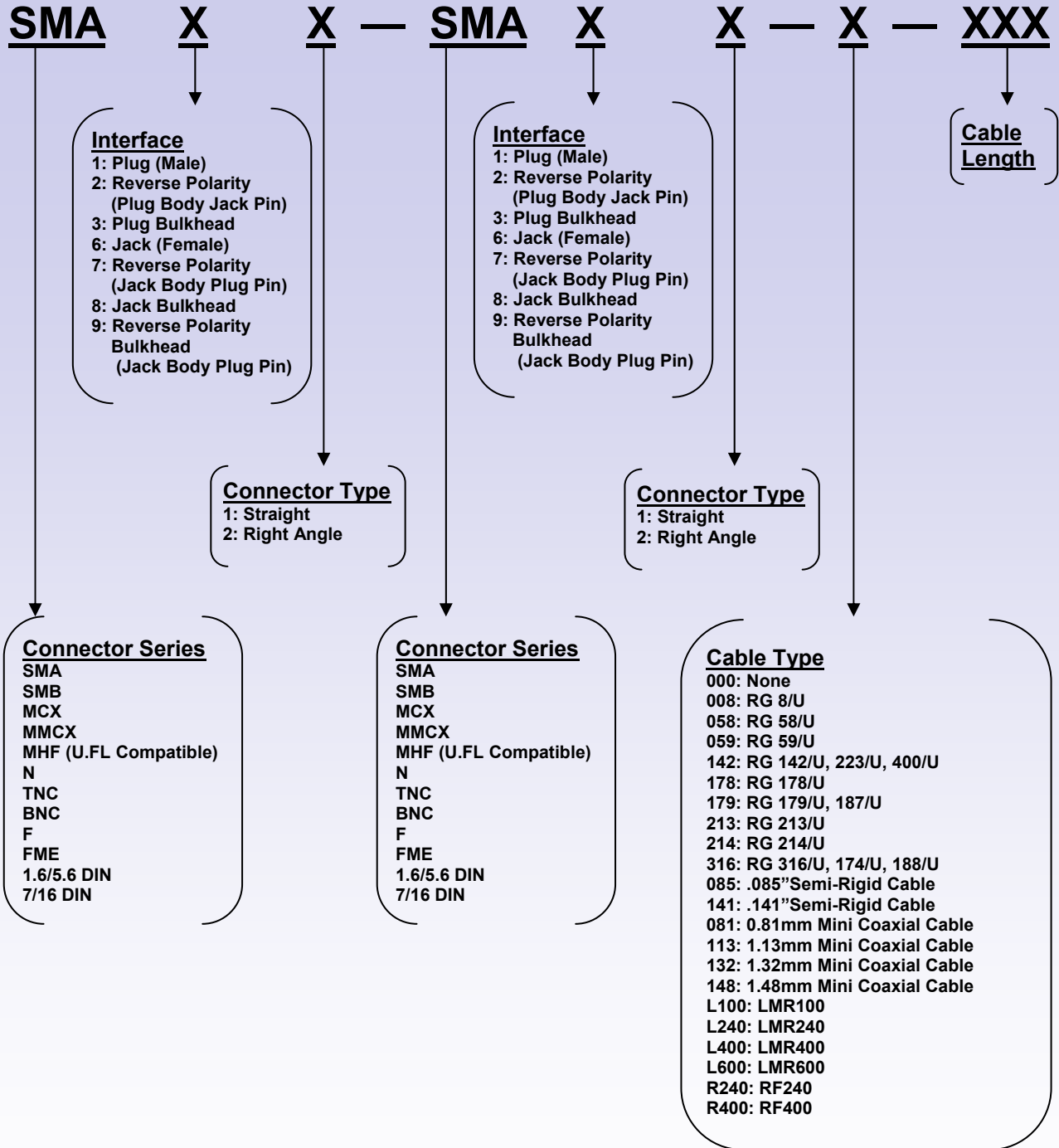

TAIWANCAST INC.

2F, No.27, Jhong-Rong St., Sin-Jhuang City, Taipei County 242, Taiwan

TEL. 886 2 8994 1601, FAX. 886 2 8994 1602, sales@rfconnector.com.tw, www.rfconnector.com.tw

1.6/5.6 SERIES

The 1.6/5.6 Series is a European design with threaded coupling provide positive mating. The compact design of the 1.6/5.6 permits dense connector packing, making these connectors ideally suited to application where space limitation is a factor.

Applications:

- ◆ Base Stations
- ◆ Computer/LAN
- ◆ Routers
- ◆ Switching Equipment
- ◆ Telecommunications
- ◆ Wireless

Interface Mating Dimensions:

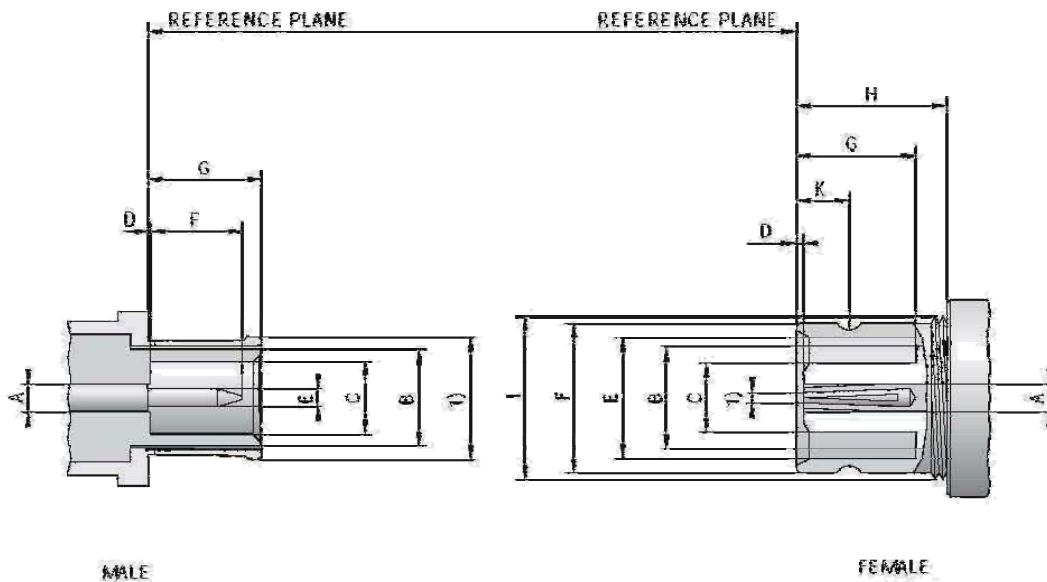

Interface Dimension in Millimeters					
Male			Female		
	Min.	Max.		Min.	Max.
A	1.60 nom		A	1.60 nom	
B	5.60 nom		B	5.60 nom	
C	4.00		C		3.80
D		0.15	D	0.25	0.75
E	0.97	1.03	E	6.60	6.69
F		5.50	F	8.10	8.25
G	6.40	6.60	G	6.70	
H			H	9.70	
			I	M9x0.5	
			K	2.90	3.10

TAIWANCAST INC.

2F, No.27, Jhong-Rong St., Sin-Jhuang City, Taipei County 242, Taiwan

TEL. 886 2 8994 1601, FAX. 886 2 8994 1602, sales@rfconnector.com.tw, www.rfconnector.com.tw

1.6/5.6 SERIES

Technical Characteristics

Electrical

Impedance	75 ohm	
Frequency Range	0 – 1 GHz	
Working Voltage	335 VRMS max.	
Dielectric Withstanding Voltage	1000 VRMS	
VSWR	Straight	1.3 max.
	Right Angle	1.5 max.
Contact Resistance	Center Contact	4 Milliohm Max.
	Outer Contact	2 Milliohm Max.
Insulator Resistance	1000 Mega ohms min.	

Material:

Part Name	Material	Finish
Body, Metal Parts	Brass	Nickel or Gold
Center Contacts	Plug: Brass	Gold
	Jack: Beryllium Copper, Phosphor Bronze	Gold
Insulator	PTFE	
Crimp Ferrule	Annealed Copper	Nickel or Gold
Clamp Gaskets	Silicone	

Mechanical & Environmental

Contact Retention	6 lbs. min.
Durability (Mating)	500 cycles min. (For Be/Cu Jack Contact only)

TAIWANCAST INC.

2F, No.27, Jhong-Rong St., Sin-Jhuang City, Taipei County 242, Taiwan

TEL. 886 2 8994 1601, FAX. 886 2 8994 1602, sales@rfconnector.com.tw, www.rfconnector.com.tw

1.6/5.6 SERIES

1.6/5.61175-1-XXX

1.6/5.6 STR. PLUG CRIMP TYPE

Suitable Cable:

(1)RG179, RG187

(2)2.5C2V

(3)3C2V



1.6/5.61275-1-XXX

1.6/5.6 R/A PLUG CRIMP TYPE

Suitable Cable:

(1)RG179, RG187

(2)2.5C2V

(3)3C2V



1.6/5.66175-1-XXX

1.6/5.6 STR. JACK CRIMP TYPE

Suitable Cable:

(1)RG179, RG187

(2)2.5C2V

(3)3C2V



1.6/5.61175-4

1.6/5.6 STR. JACK P.C.B. MOUNT



1.6/5.66275-1-XXX

1.6/5.6 R/A JACK CRIMP TYPE

Suitable Cable:

(1)RG179, RG187

(2)2.5C2V

(3)3C2V



TAIWANCAST INC.

2F, No.27, Jhong-Rong St., Sin-Jhuang City, Taipei County 242, Taiwan

TEL. 886 2 8994 1601, FAX. 886 2 8994 1602, sales@rfconnector.com.tw, www.rfconnector.com.tw